

PRODUCT DESCRIPTION

The basic material we use for Varion canopy manufacturing is Aluminium, where we first construct a main frame on which based on customers' product specification both sides where pre-laminated aluminium sheet is applied and finally finished with an extruded edge profile. During the assembling process we can add an acoustical filler based on mineral wool providing high sound absorption performance.

Canopies are supplied in 2 basic shapes:

CARVE UP concave shape

CARVE DOWN convex shape

Canopy size is 118x178cm fitted with a discrete shadow gap into a module of 120x180cm

JOBSITE CONDITIONS

Ceiling canopies should be stored for min. 24 hours allowing to reach room temperature and have established moisture content

Panels must be stored in original packaging and by that protected against damage ,moisture, surface and edge damage. Building areas should be free of construction dust and debris before

After the installation is complete maximum room humidity must not exceed 95%RH relative humidity.

Canopies are not to be used for external installation.

STORAGE AND LOGISTICS

The ceiling components shall be stored in a dry interior location and shall remain in original cartons prior to installation to avoid damage. The cartons shall be stored in a flat, horizontal position.

Canopy should remain in original carton with delivered corner and edge protection until installation is complete as instructed in bellow specified steps.

GENERAL INSTRUCTION

To avoid damages and assure appropriate safety conditions for product handling and installation 2 persons are advised to perform installation.

Please follow carefully installation steps and DO NOT remove original packaging, corner and edge protection from the product before detailed recommendation as follows .

ANCHORING PLAN

For easier final product levelling we recommend to level suspension wires as close to vertical line as possible!

Presented scheme is valid only for horizontal Canopy installation up to max.5 ° deviation in x and y axis.

Please download suspension point position matrix from our WEB page to be used for installation with other Canopy position scenarios.

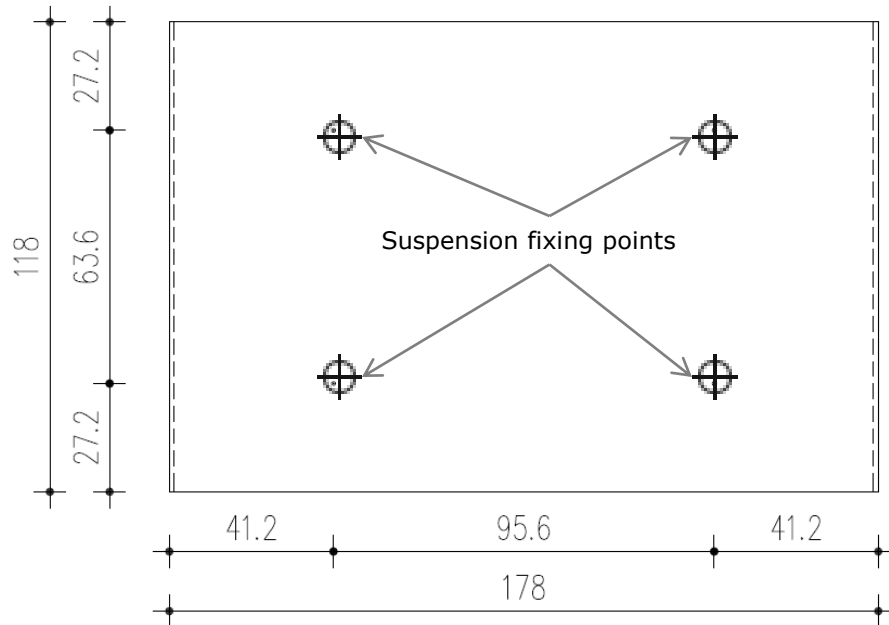

1. STEP - ANCOR installation

1. Canopy in carton box is to be placed on flat, horizontal surface with the side marked with company logo and product details faced UP.

Please carefully remove upper part of the carton by using carpenter knife . (adjust blade on max.5 mm in order to avoid product damage)

For better accuracy and easier alignment we advice to draw anchoring plan on the soffit when installing larger number of Ceiling canopies.

2. We do supply different anchors for specified structure material. Please use appropriate and specified anchor .

Optionally we supply anchors for concrete, wood, steal beam, plaster board and clips for "T" suspension profiles.

3. Fasten "barrel end" with integrated suspension wire in preinstalled anchor

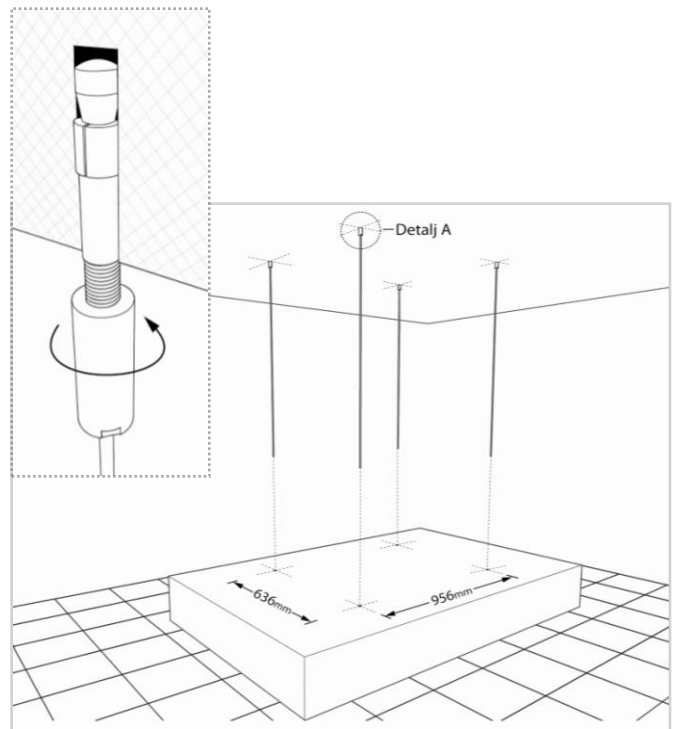

2.STEP - Gripple tensiner installation and cable attachment to a canopy

- 1 Please place Canopy in a carton box under the final installation position on flat and horizontal surface.
- 2 Insert free wire end into a middle opening on a Gripple tensiner and pull the wire to position the tensiner approx 10cm above canopy suspension eye.
3. Pull free wire end into canopy suspension eye and return on the lower side into middle opening on Gripple tensiner
4. Repeat above specified steps on all 4 wires
5. By pulling free wire end we slightly lift a canopy to separate from the box. For better final visual appearance and easy levelling we recommend to keep Gripple tensiner as close as possible to the canopy while pulling the wire.

In this step carton box is remaining on the floor.

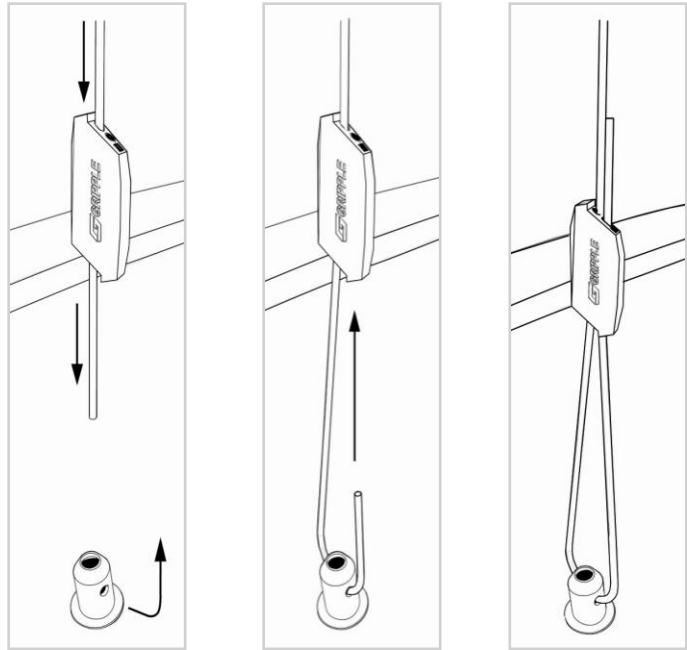

3 STEP - Final positioning

1. By pulling symmetrically all 4 suspension wires we lift a canopy on the required position. To avoid wire damage while lifting we do recommend second person to assist in lifting the canopy.
2. To avoid damages on edge and corners we recommend to keep corner protection on the canopy until all ceiling and service installation is complete .

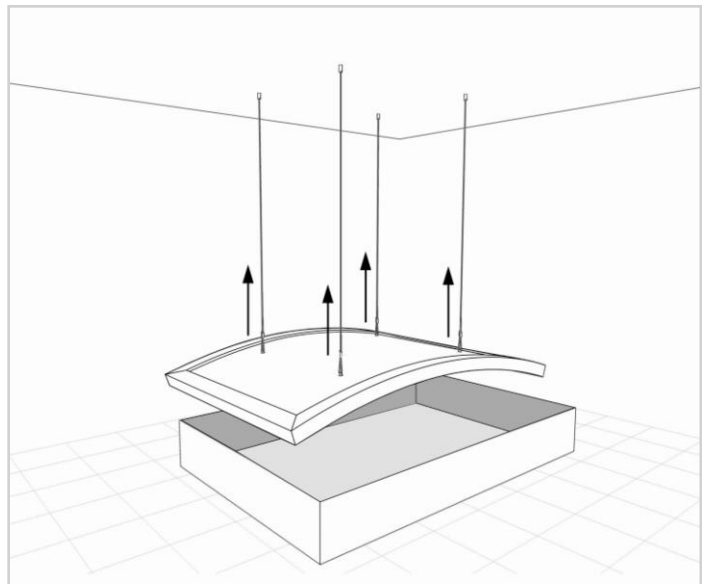

4. STEP - Final levelling

1 To lower the wire we need Gripple pin supplied in a standard suspension kit. To release the wire we do insert the pin in a smallest opening on the Gripple tensioner side with a free wire . By removing the pin again a tensioner automatically blocs the wire.

2. Lowest canopy point is to be min.2,30 m from floor level

When canopy is installed on final position extensive cable is to be cut by leaving approx 30mm free wire end , or we keep it in roll laying on the top of the canopy. Logically we recommend this to be done only when upper canopy side is not visible.

In case of expected Canopy relocating we must keep wires in full length to allow necessarily re-installation without product damages.

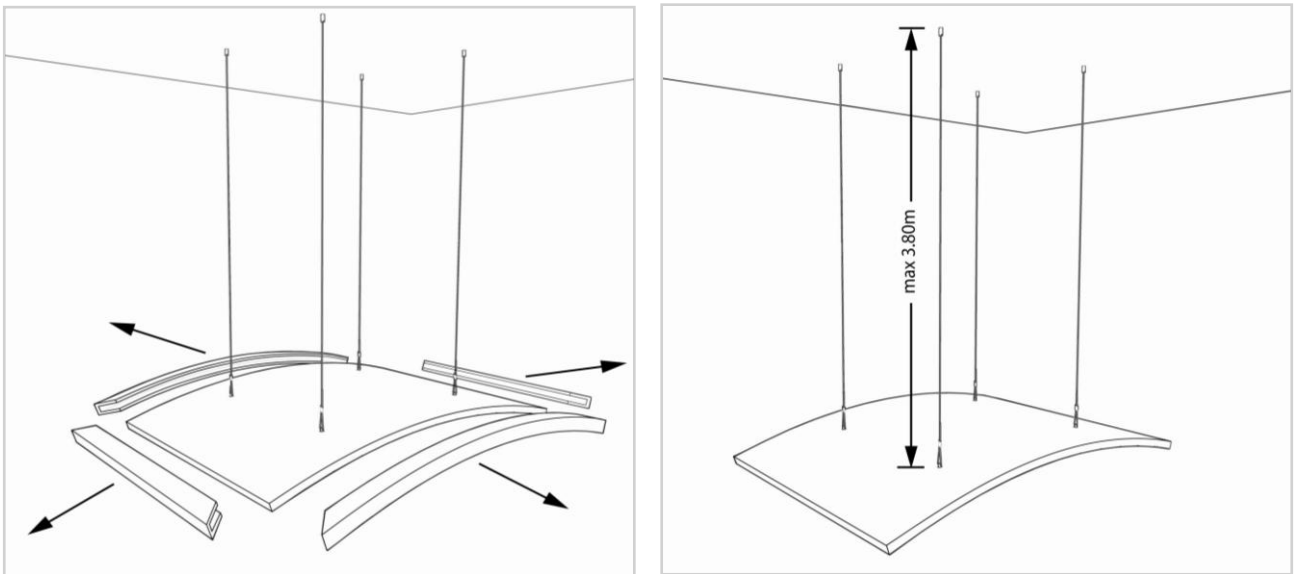

LIGHTING INTEGRATION

Varion Ceiling Canopies can be optionally supplied with integrated LED light elements. Please follow separate attached installation manual in such cases .

All lighting elements installed for indirect lighting should be suspended from the soffit independently. Any kind of additional load or lighting installation on Ceiling canopy is possible only prior consultancy and technical specification form our technical department.

TECHNICAL SUPPORT

For all additional technical support on Ceiling canopies installation and product application please consult with our authorised distribution and contracting partners as well as our technical department.

Contacts can be found on our WEB page: www.varion.si , optionally you can mail your request on our E-mail: info@varion.si

